

# EMD300



## Features

- 550 TVL of super high resolution
- 3-axis positioning for flexible selection of viewing angle
- Video module can be rotated through 360° for direction, 180° for elevation and 360° on axis
- Vandal resistant with polycarbonate dome cover to withstand intentional damage
- Waterproof IP67 rated
- Die-cast aluminum black or white color base to choose from
- Low current consumption of 80mA
- Pan 360° / Tilt 160°
- Day/Night Operation

**550**  
TVL

  
Day Night

  
Waterproof  
IP67

**POWER**  
12VDC

  
Vandal  
Resistant

## Specifications

<b>Part Number</b>	<b>EMD300</b>
<b>Pickup Device</b>	1/3" Sony Super HAD CCD II
<b>Video Format</b>	NTSC or PAL
<b>Picture Elements</b>	768 x 494 (NTSC)   768 x 494 (NTSC)
<b>Scanning System</b>	2:1 Interface
<b>Horizontal Resolution</b>	550 TVL
<b>Sensitivity</b>	0.05 Lux
<b>S/N Ratio</b>	More than 45dB (AGC Off)
<b>Electronic Shutter</b>	NTSC: 1/60 -100,000 sec. PAL: 1/50 - 1000,000 sec.
<b>Video Output</b>	1.0 Vp-p Composite (75Ω)
<b>Gamma Correction</b>	0.45
<b>Lens Type</b>	f=3.6 mm fixed board lens
<b>Sync Mode</b>	Internal
<b>Day/Night</b>	Day/Night operation
<b>Environmental</b>	IP67
<b>Power Source</b>	12VDC
<b>Power Consumption</b>	12VDC (±10%), Max. 1W
<b>Operating Temp</b>	14°F~122°F   -10°C~50°C
<b>Dimensions (in l mm)</b>	3.2" x 2.5" (bubble: 2.3") l
<b>Weight (lbs l gm)</b>	0.48 lbs. l
<b>Vandal</b>	Resistant
<b>Certifications</b>	CE, FCC, RoHS

## Dimensions: mm/in

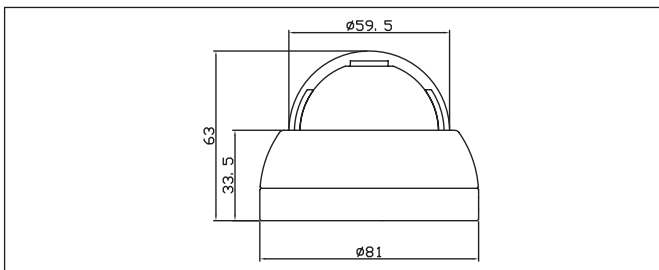

## Ordering Info

- EMD300/B:** Day/Night, 3.6mm, Black  
**EMD300/W:** Day/Night, 3.6mm, White

